

Door Hinge Kit Replacement

CL SERIES, FX SERIES, ENTRANCE DOORS

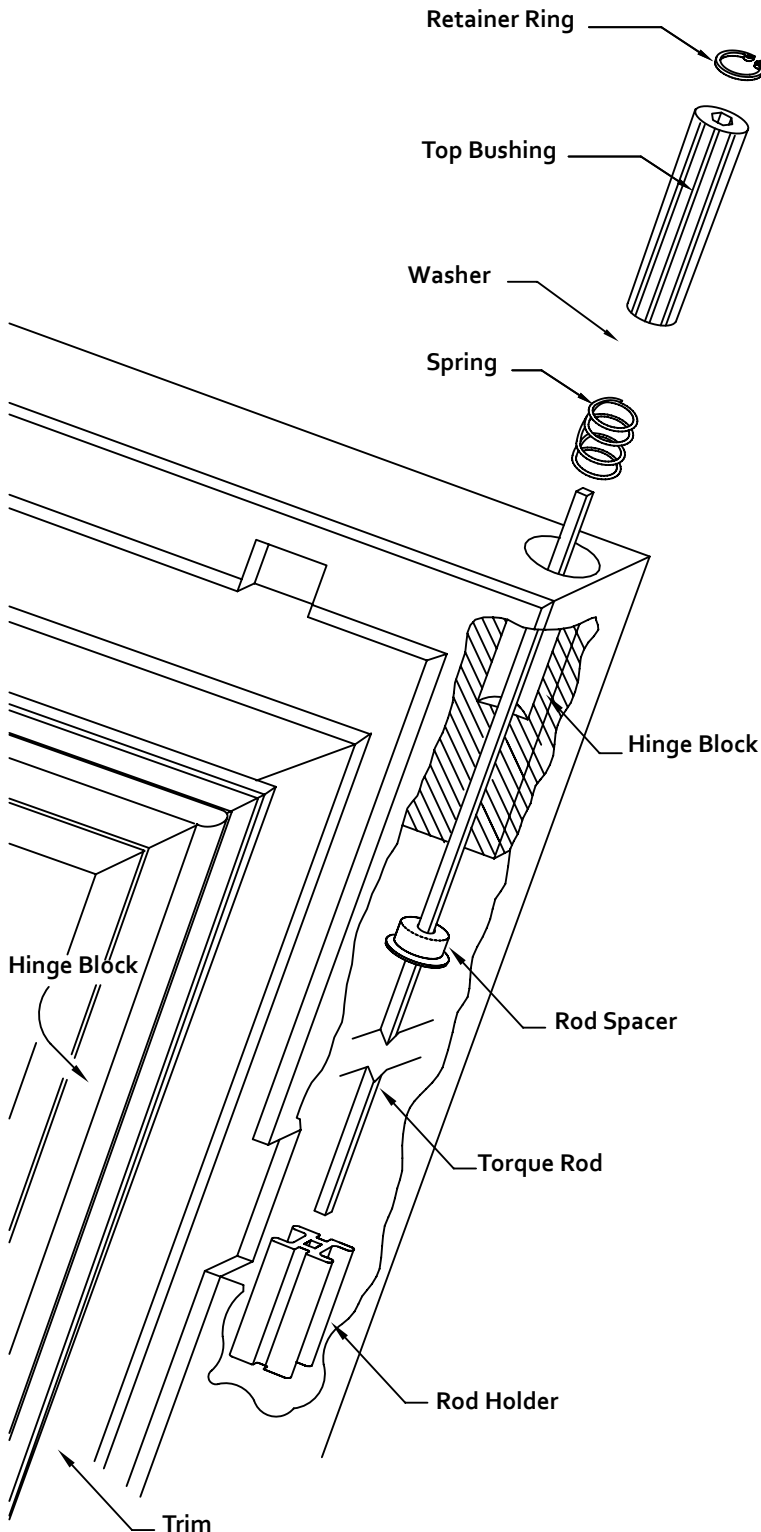

REMOVE DOOR FROM FRAME

- Holding the top hinge pin with a 5/16" wrench loosen the 11/16" lock nut. This will release the spring tension.
- Open the door and remove the two screws from the door plug. Then unplug the cord from the frame. With the door open about 90°, lift the hold open CAM off the slide pin.
- With the door open about 90°, lift the hold open CAM off the slide pin.
- Lift the door up and out off the bottom hinge pin.

REMOVE THE RETAINER RING FROM THE TOP HINGE HOLE BY COM- PRESSING THE OPEN ENDS TOGETHER.

- Pull the top hinge bushing from the door. If it is still attached to the torque rod, do not pull it more than 6" out of the door. If the bushing is not attached to the torque rod, pull the torque rod from the top hinge hole, but not more than 6".
- To replace the top hinge bushing, hold the torque rod and pull old bushing off. If bushing is black, remove old spring from torque rod and slide new spring & washer in place. If bushing is not black, do not remove spring. To install new top hinge bushing align square of torque rod to square hole in top hinge bushing and tap onto torque rod.
- The torque rod and hinge bushing can now be pushed back into the door. Top hinge bushing should go low enough to expose retainer clip groove. If groove is not visible, then the top hinge bushing is not far enough on the torque rod. Once the groove is visible, then replace the retainer ring by compressing the open ends.

Note: before replacing door remove existing nylon bearing from bottom hinge pin and install new bearing in place.

- Replace door by engaging top hinge pin into top bushing of door and lift door over bottom hinge pin allowing door to drop into proper position.

TO ADJUST DOOR TENSION:

- Using a 5/16" wrench on top hinge pin, turn toward direction of door closing to increase tension.
- Tighten top lock nut.

Note: before replacing door remove existing nylon bearing from bottom hinge pin and install new bearing in place.

Tools Required:

- 5/16" Wrench
- 11/16 Wrench
- Hammer
- Retainer Ring Pliers