

# Automatic Beer Cave Door

A NEW GENERATION OF AUTOMATIC DOORS

## KEEP THIS GUIDE

# Styleline® ABC

## NEW SYSTEM IMPROVEMENTS & IMPORTANT INFORMATION

### BRUSHLESS MOTOR

- Long lifespan, silent operation, smooth and secure leaf control.

### ELECTROMECHANICAL LOCKING

- Built into the mechanism to firmly lock the doors.

### EMERGENCY BATTERY

- Backup in the event of a power loss.

### CONTROLS

- Smartphone.
- NAVIBLU console / Infrared remote control.
- Contactless switches.
- Radio switches (wireless).
- Emergency door release.

### SYSTEM OPERATION VIDEO TUTORIAL

- Basic system operations.
- Open YouTube app and search for **T85wdY1MXGI**

**Note:** Some operation/features do not apply.

### NAVIBLU DIGITAL DISPLAY

- Optional to install.
- Can be mounted to the wall or side jamb cover.
- Displays current door status, mode, error codes.
- Radio switches (wireless).
- Emergency door release.
- VisiBlu no longer available.



NAVIBLU Digital Display Front Side

LCD Display

Control Buttons

### SMARTPHONE BASED CONTROL



- Door status, mode selection, passage width adjustment, controlled opening/closing, priority opening, fault history, language selection, clock, etc.

### DOWNLOAD AUTODOOR PILOT APP



AUTODOOR PILOT

Portals

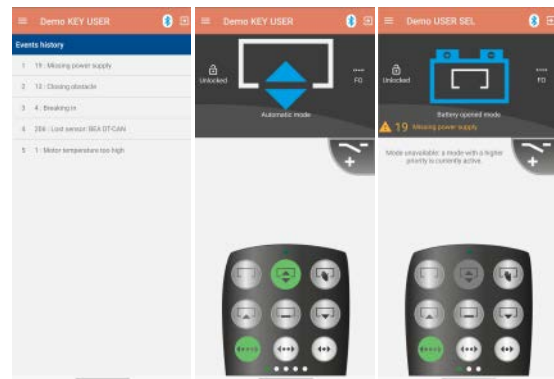

### SCAN QR CODE TO DOWNLOAD PILOT APP



SCAN ME

Android



SCAN ME

iOS



- Download and install Pilot app.
- Once installed, pair app with header by scanning QR code located by circuit board inside the header.

PAIR APP WITH THIS QR CODE

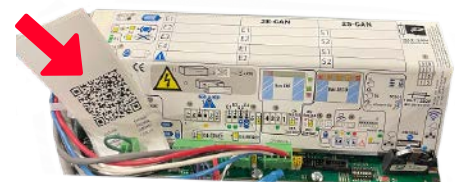

# Automatic Beer Cave Door

A NEW GENERATION OF AUTOMATIC DOORS

# Styleline® ABC

## NAVIBLU DIGITAL DISPLAY INSTALLATION



### BEFORE YOU BEGIN:

Read these instructions completely and carefully.

### FOR YOUR SAFETY:

Read and observe all CAUTIONS and WARNINGS shown throughout these instructions.



This warning does not mean that STYLELINE® products will cause cancer or reproductive harm, or is in violation of any product-safety standards or requirements. As clarified by the California State government, Proposition 65 can be considered more of a 'right to know' law than a pure product safety law.

When used as designed, STYLELINE® believes that our products are not harmful. We provide the Proposition 65 warning to stay in compliance with California State law. It is your responsibility to provide accurate Proposition 65 warning labels to your customers when necessary. For more information on Proposition 65, please visit the California State government website.



### CAUTION:

**Risk of injury.** While performing installations described, gloves and safety goggles should be worn.



### WARNING:

Altering system from original equipment manufacturer specs will void warranty.

### WARNING:

**Risk of electrical shock.** Disconnect power before servicing or installing product. Switch the power off at the service panel and follow appropriate lock out/tag out safety procedures.

- 1) Drill 1/2" hole centered on the jamb cover 4" from the top end. **(Figure 1)**
- 2) Connect red, white, black and green wires from **header** to the back of NAVIBLU digital display as shown on. **(Figure 2)**
- 3) Peel and stick display unit with hole centered on jamb hole. **(Figure 3)**

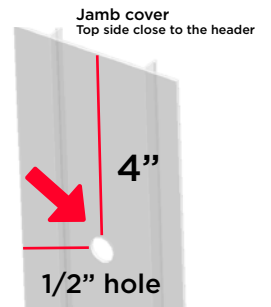
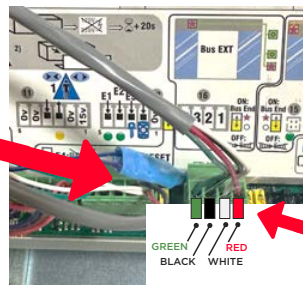

Figure 1



Figure 2



ABC System Header Circuit Board



NAVIBLU Digital Display Circuit Board

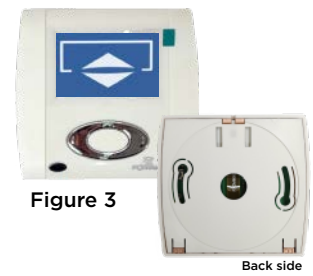

Figure 3

Back side

# Automatic Beer Cave Door

A NEW GENERATION OF AUTOMATIC DOORS

Styleline<sup>®</sup> **ABC**

## AUTODOOR PILOT APP

### AUTODOOR PILOT

Control your automatic door remotely through your smartphone

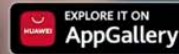

CONTROL YOUR AUTOMATIC DOOR USING YOUR SMARTPHONE

# Automatic Beer Cave Door

A NEW GENERATION OF AUTOMATIC DOORS

Styleline® **ABC**

## AUTODOOR PILOT APP FEATURES

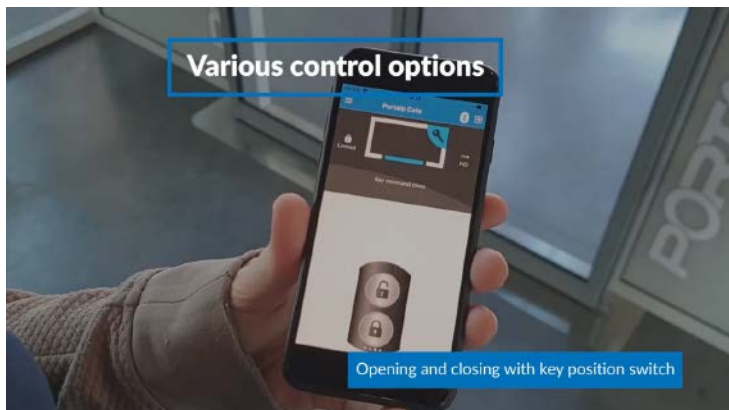
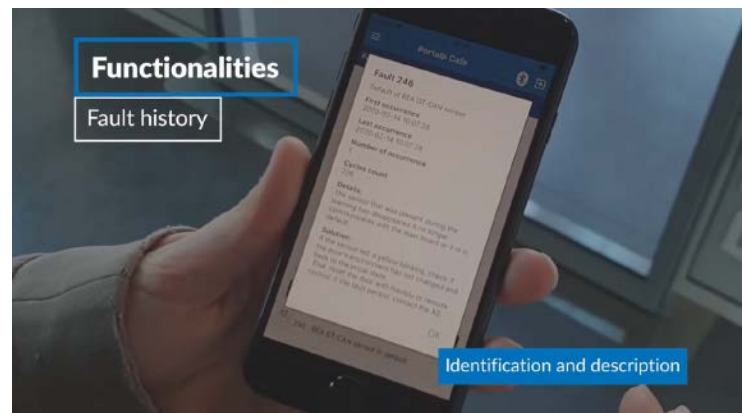
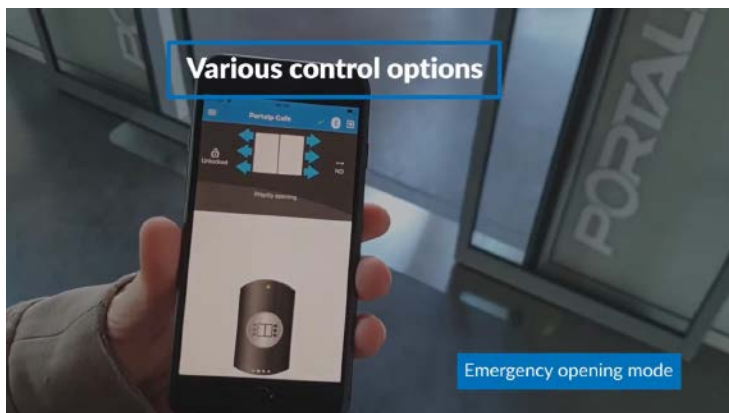
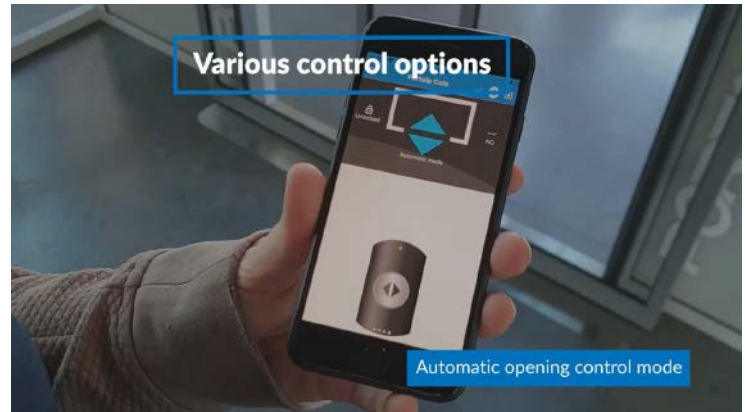
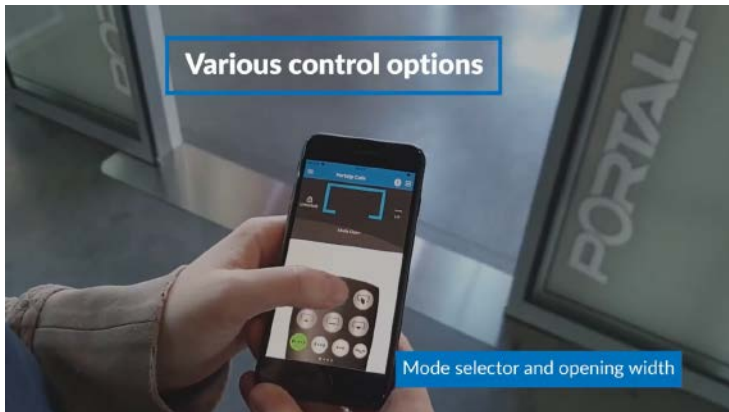

# Fully Control Your System!

# Automatic Beer Cave Door

A NEW GENERATION OF AUTOMATIC DOORS

# Styleline® ABC

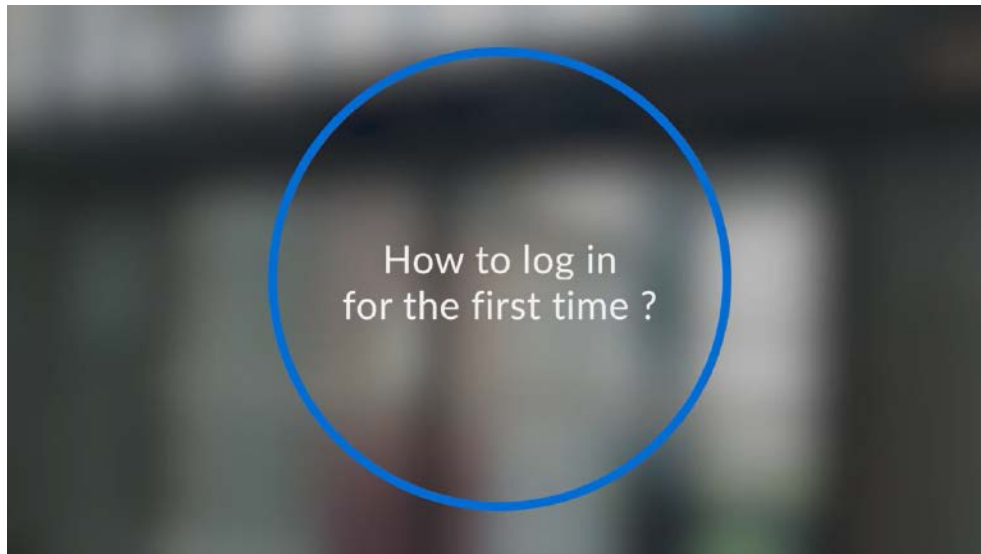

## Step 1: Download, install and open app.

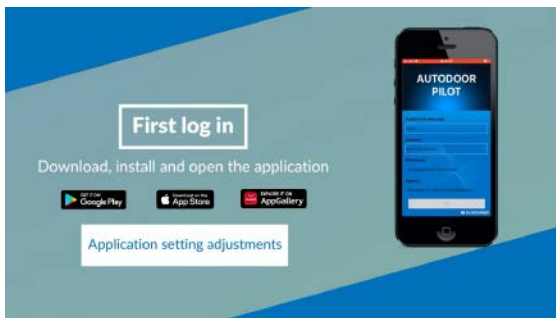

## Step 3: Scan or enter pairing code located inside system header.

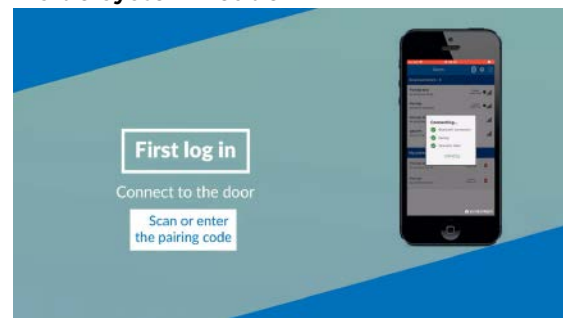

## Step 2: Connect to door via Bluetooth.

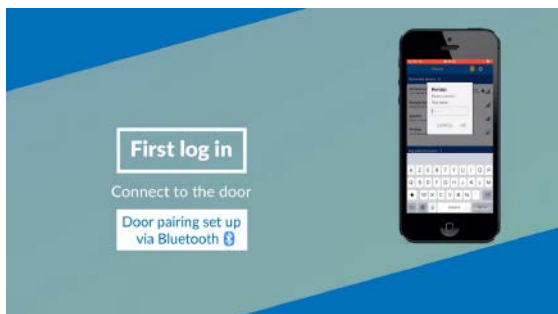

## Step 4: Control automatic door.

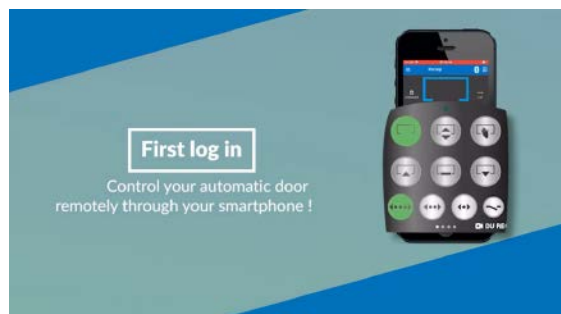

Click here to watch full tutorial: [www.youtube.com/watch?v=T85wdY1MXGI](http://www.youtube.com/watch?v=T85wdY1MXGI)

**Note:** Some operation/features do not apply.

# Automatic Beer Cave Door

A NEW GENERATION OF AUTOMATIC DOORS

# Styleline<sup>®</sup> ABC

## TROUBLESHOOTING

Action	Mode/Fonction	Mode/Function
	Choix des modes   Modes choice	
	Automatique Automatic	Fermé   Closed
	Sortie   Exit	Ouvert   Opened
	Entrée   Entry	Manuel   Manual
	Dé/verrouillage clavier Keyboard un/locking	Mode petite ouverture Small opening
	Configuration Configuration	Diagnostic Diagnosis
	Consultation Consultation	Reset hard Hard reset



## SYSTEM CODES DEFINITIONS

Num	Default	Num	Default
01	Temp. moteur trop élevée Motor temp. too high	12	Obstacles en Ouverture Obstacle on Opening
02	Batterie faible Battery low	13	Obstacles en Fermeture Obstacle on Closing
04	Effraction Breaking in	14	Carte SD non présente SD card not present
05	Carte SD Défectueuse SD card faulty	15	Largeur trop Importante Width too wide
06	Capteur temp. moteur défectueux Motor temp sensor. faulty	16	Largeur trop Petite Width too small
07	Fusible puissance carte base HS Fuse for motherboard power blown	17	Test Batterie non effectué Battery test not performed
10	Défaut Moteur Motor fault	18	Dispositif issue de secours Emergency exit device
11	Courroie cassée Broken belt	19	Perte Secteur Mains power loss